



FORD 2021-22 Bronco 2” Lift Kit

Thank you for choosing Rough Country for all your vehicle needs.

Rough Country recommends a certified technician install this system. In addition to these instructions, professional knowledge of disassemble/reassembly procedures as well as post installation checks must be known. Attempts to install this system without this knowledge and expertise may jeopardize the integrity and/or operating safety of the vehicle.

Please read instructions before beginning installation. Check the kit hardware against the parts list. Be sure you have all needed parts and know where they go. Also please review tools needed list and make sure you have needed tools. If question exist, please call us @1-800-222-7023. We will be happy to answer any questions concerning this product. Check all fasteners for proper torque. Check to ensure for adequate clearance between all components. Periodically check all hardware for tightness.

PRODUCT USE INFORMATION

▲WARNING The taller a vehicle is, the easier it will roll. We strongly recommend, because of rollover possibility that seat belts and shoulder harnesses should be worn at all times. Avoid situations where a side rollover may occur.

▲WARNING Generally, braking performance and capability are decreased when larger/heavier tires and wheels are used. Take this into consideration while driving. Do not add, alter, or fabricate any factory or after-market parts to increase vehicle height over the intended height of the Rough Country product purchased. Mixing component brands is not recommended.

Rough Country makes no claims regarding lifting devices and excludes any and all implied claims. We will not be responsible for any product that is altered. If questions exist we will be happy to answer them concerning the design, function, and correct use of our products.

The suspension system was developed using a 315/70R17 tire with a 17 x 8.5 wheel with +35mm offset. The lifts were designed to lift the front to level the vehicle. Due to manufacturing, dimension variances, and inflation all tire and wheel combinations should be tested prior to installation on all oversized / wider then stock tires.

▲NOTICE DEALER AND VEHICLE OWNER

Any vehicle equipped with any Rough Country product should have a “Warning to Driver” decal installed on the inside of the windshield or on the vehicle’s dash. The decal should act as a constant reminder for whoever is operating the vehicle of its unique handling characteristics.

Torque Specs:

Size	Grade 5	Grade 8	Size	Class 8.8	Class 10.9
5/16"	15 ft/lbs	20ft/lbs	6MM	5ft/lbs	9ft/lbs
3/8"	30 ft/lbs	35ft/lbs	8MM	18ft/lbs	23ft/lbs
7/16"	45 ft/lbs	60ft/lbs	10MM	32ft/lbs	45ft/lbs
1/2"	65 ft/lbs	90ft/lbs	12MM	55ft/lbs	75ft/lbs
9/16"	95 ft/lbs	130ft/lbs	14MM	85ft/lbs	120ft/lbs
5/8"	135ft/lbs	175ft/lbs	16MM	130ft/lbs	165ft/lbs
3/4"	185ft/lbs	280ft/lbs	18MM	170ft/lbs	240ft/lbs

Alignment Specs

Front	
Caster	3.18° ± 0.60°
Camber	0.12° ± 0.50°
Toe	0.1° ± 0.15°



Kit Contents:
Strut Spacers x4

Tools Needed:
10mm Socket/Wrench
15mm Socket/Wrench
17mm Socket/Wrench
18mm Socket/Wrench
19mm Socket/Wrench
21mm Socket/Wrench

Hardware Included:
10mm Stud Bag x2
12mm x 75mm Bolts x4
12mm Flange Lock Nuts x4
10mm Lock Nuts x2 (Not Used in this Kit)



FRONT INSTALLATION INSTRUCTIONS

1. Jack up the front of the vehicle and place on jack stands. Remove the front wheels.
2. Remove the skid plates using a 15mm socket and unplug the rack and pinion.
3. Remove the tie rod end using a 21mm socket/wrench. Strike the knuckle with a hammer if needed to remove the tie rod end. **See Photo 1 and Photo 2.**

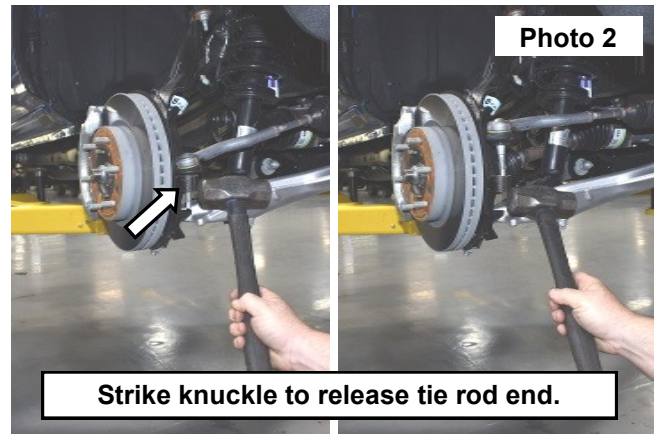
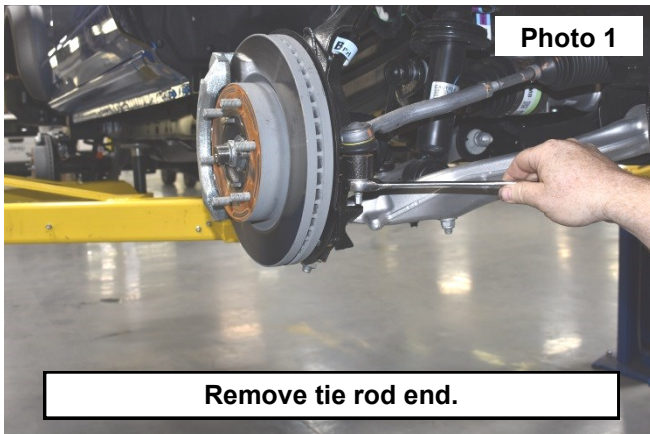

4. Remove the ABS wire and brake line from the knuckle using a 10mm socket/wrench. **See Photo 3.**
5. Remove upper ball joint just using an 18mm socket/wrench. Strike knuckle with a hammer if needed. **See Photo 4.**

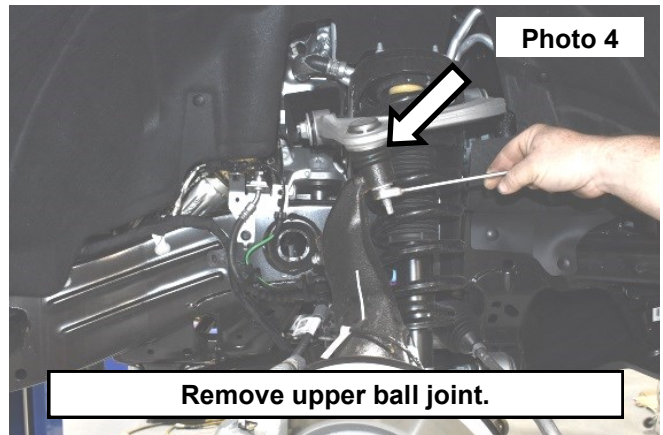
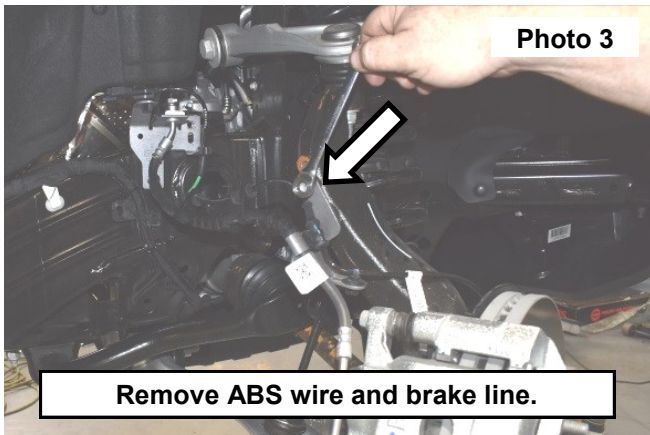

6. Remove the lower sway bar nut using a 21mm socket/wrench. **See Photo 5.**
7. Remove the lower strut bolts using an 18mm socket/wrench. **See Photo 6.**

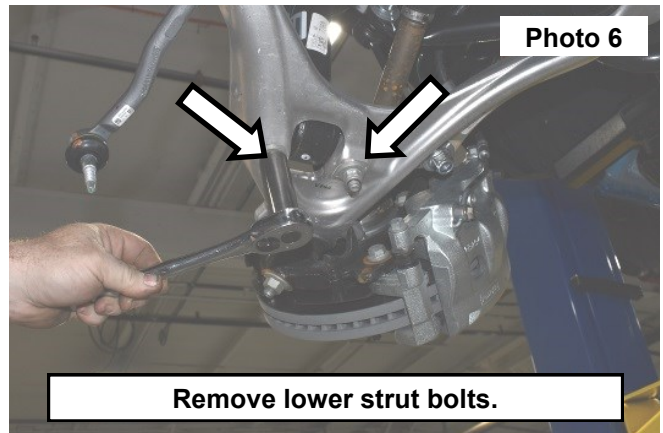
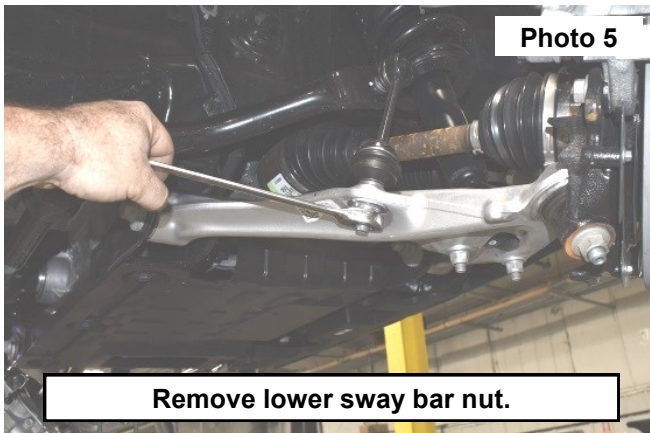

8. Remove the upper strut nuts using a 15mm socket/wrench. **See Photo 7.**
9. Remove the axle nut using a 36mm socket/wrench. Strike with hammer to loosen if needed. **See Photo 8.**

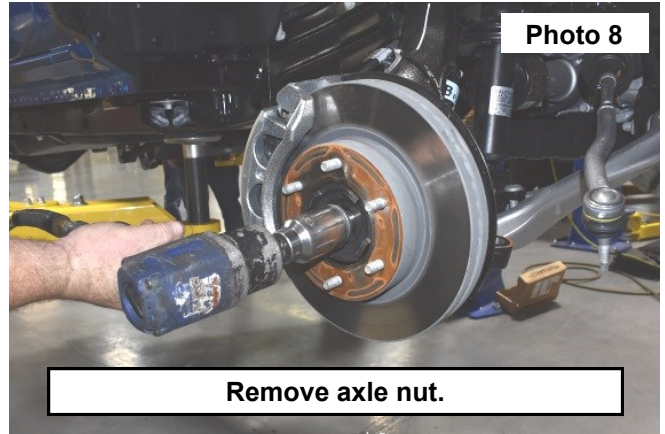
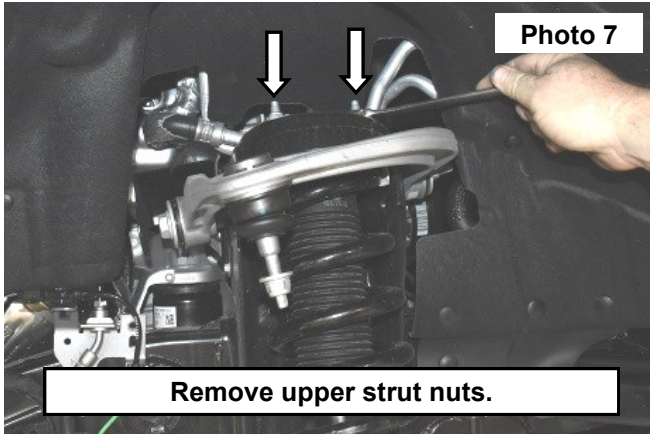

10. Remove the strut from the vehicle. **See Photo 9.**
11. Remove the lower strut studs. **See Photo 10.**

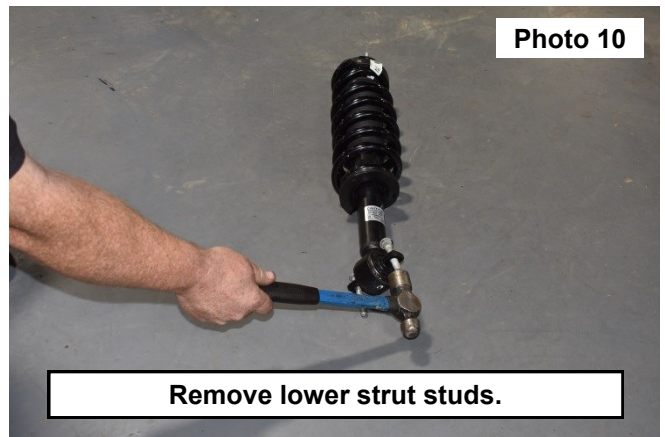
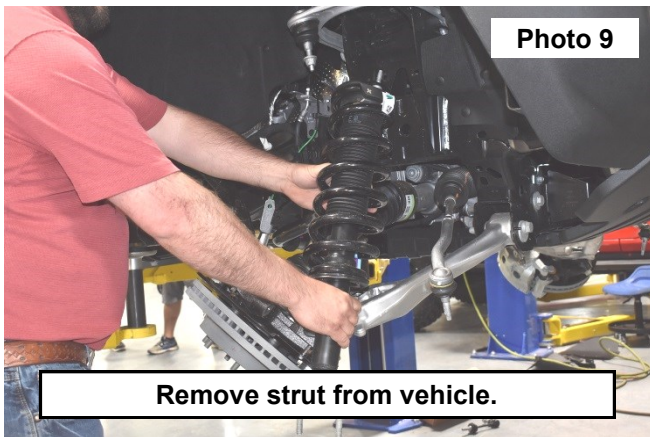

12. Remove the roll pin from strut. **See Photo 11.**
13. Install the 10mm studs in upper strut spacer and install spacer on the strut using stock hardware. **Photo 12.**

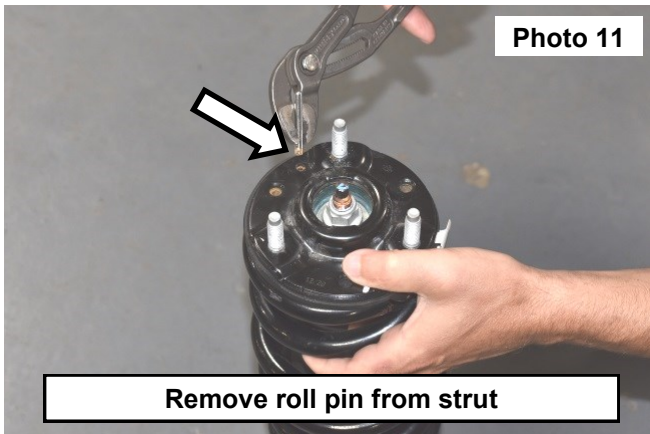

14. Reinstall the strut with the spacer using the 10mm hardware and 17mm socket/wrench. **See Photo 13.**

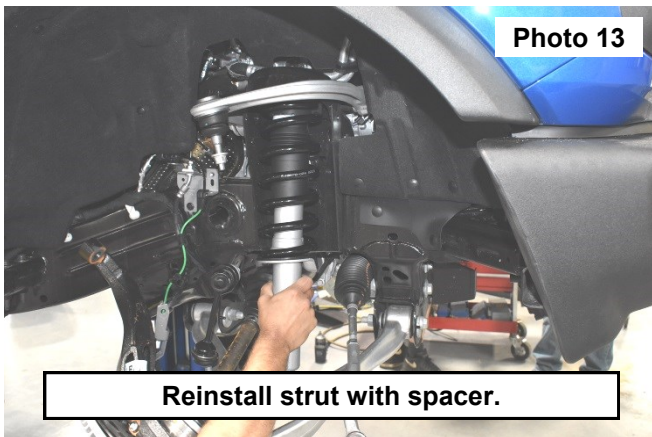

15. Reinstall stock hardware in reverse order.
16. Put on the wheels and lower.



REAR INSTALLATION INSTRUCTIONS

1. Jack up the rear of the vehicle and place on jack stands. Remove the rear wheels.
2. Remove the track bar using a 24mm socket/wrench. **See Photo 1.**
3. Support the axle and remove the lower strut bolt using a 1-1/16" socket/wrench. **See Photo 2.**

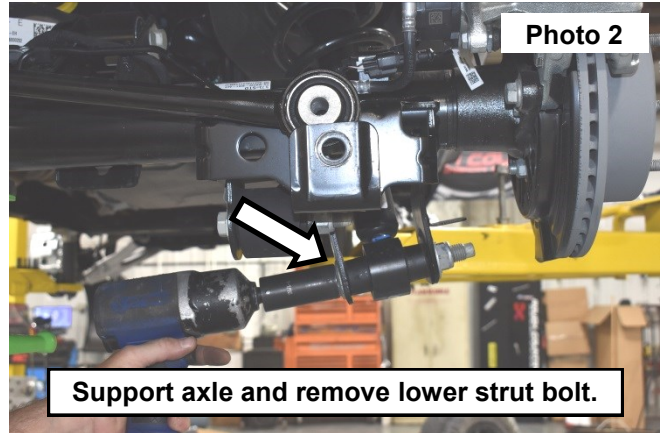
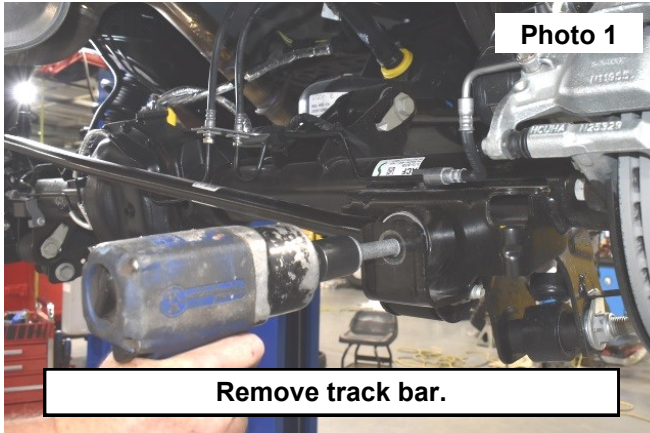

4. Remove the ABS/emergency wiring harness from the differential using an 8mm socket/wrench. **See Photo 3.**
5. Remove the clip holding the inner fender using a screw driver. **See Photo 4.**

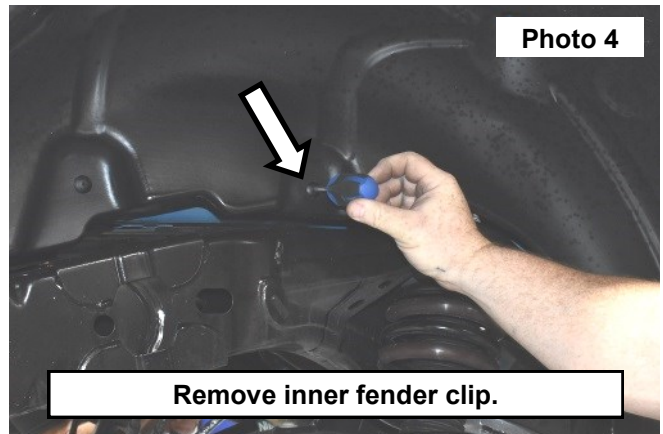
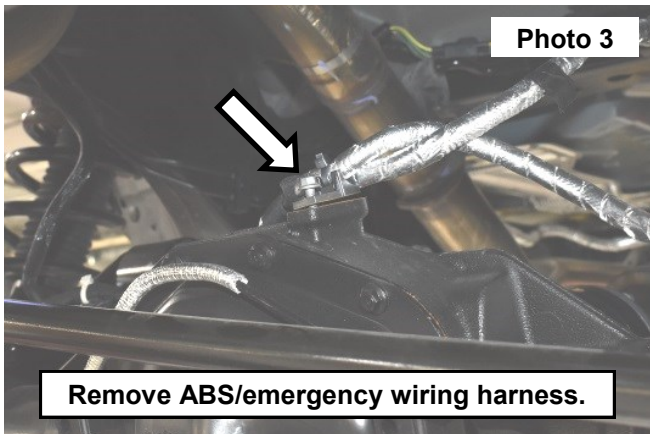

6. Remove the upper strut nuts using a 15mm wrench and remove strut from vehicle. **See Photo 5.**
7. Remove the roll pin from the strut. **See Photo 6.**

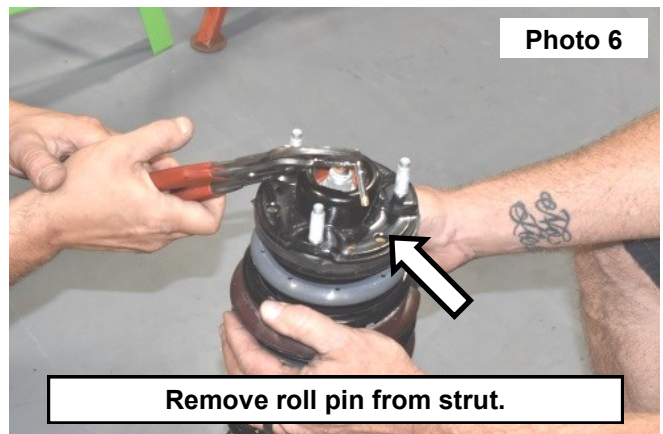
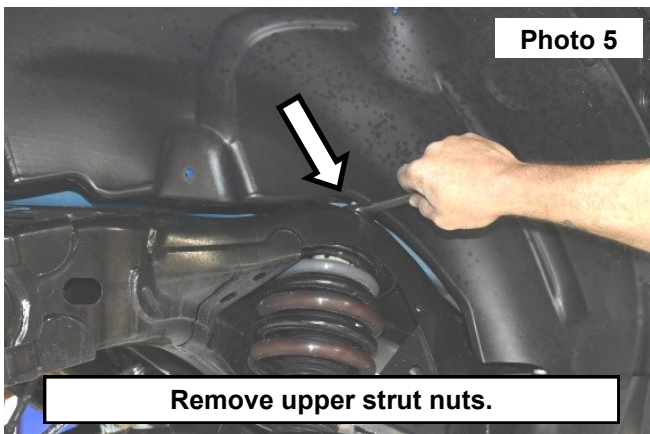

8. Install the 10mm studs in the upper strut spacer and install spacer on the strut using stock hardware. **See Photo 7.**
9. Reinstall the strut with the spacer using the 10mm hardware and 17mm wrench. **See Photo 8.**

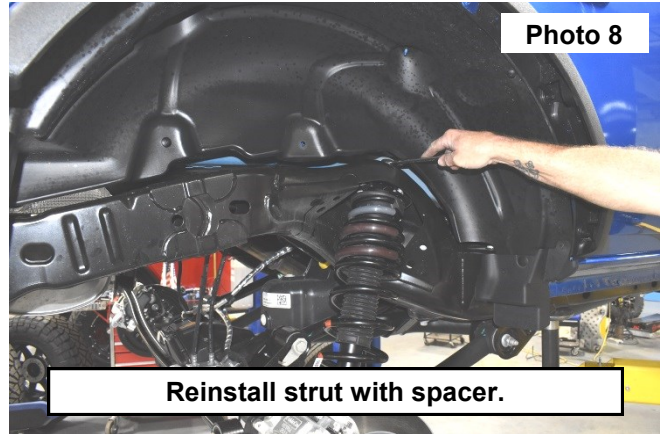
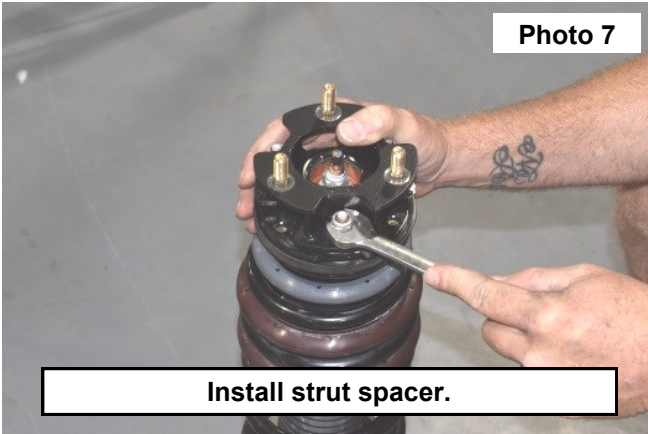

By purchasing any item sold by Rough Country, LLC, the buyer expressly warrants that he/she is in compliance with all applicable, State, and Local laws and regulations regarding the purchase, ownership, and use of the item. It shall be the buyers responsibility to comply with all Federal, State and Local laws governing the sales of any items listed, illustrated or sold. The buyer expressly agrees to indemnify and hold harmless Rough Country, LLC for all claims resulting directly or indirectly from the purchase, ownership, or use of the items.

